

SERVICE ENTRANCE CONDUCTOR SHALL EXTEND A MIN. 2'-0" OUT OF WEATHERHEAD. NEUTRAL SHALL BE CLEARLY MARKED.

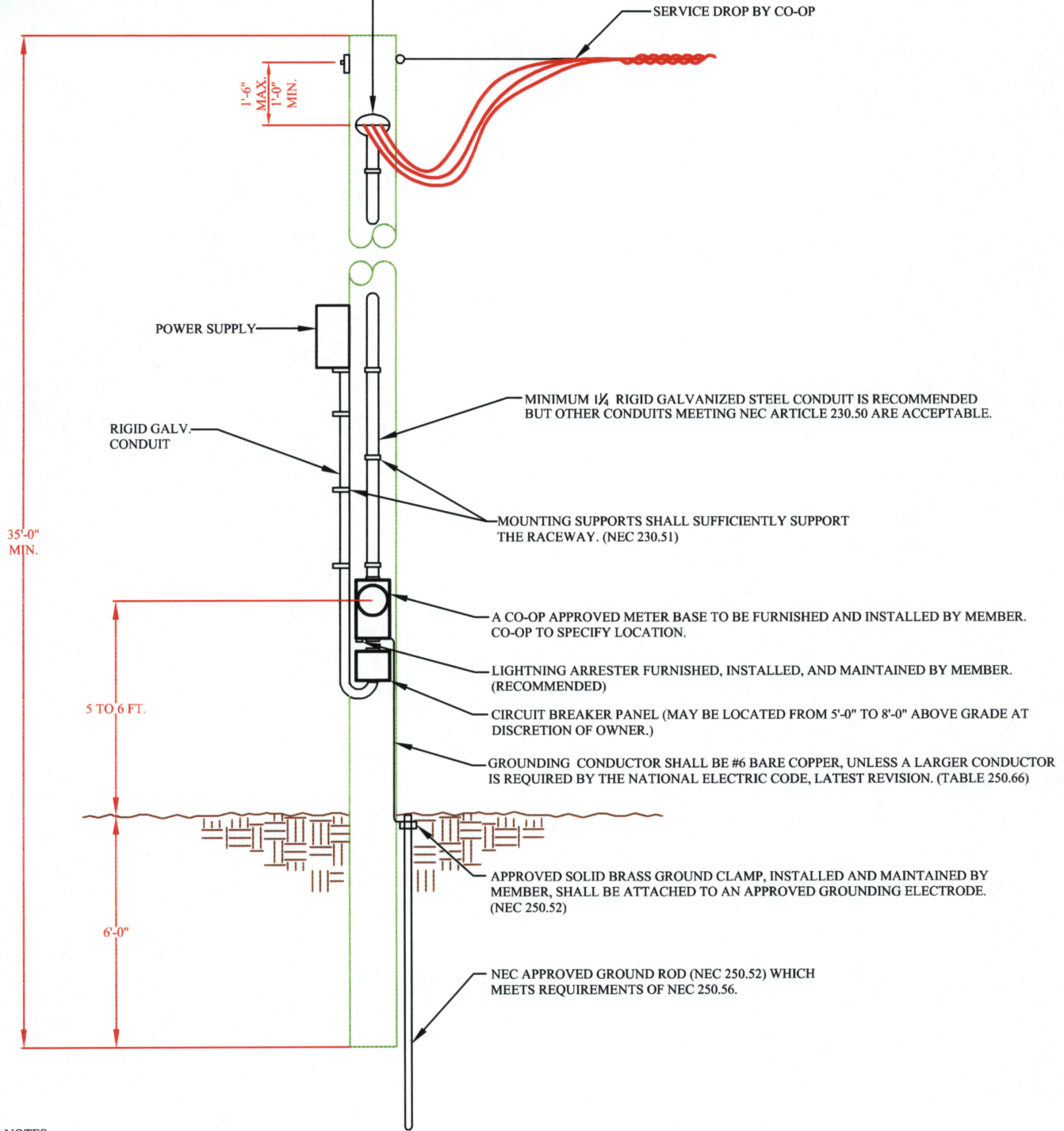

NOTES

1. THE MINIMUM HEIGHT OF A SERVICE DROP ACROSS A DRIVEWAY IS 16'-0" UNLESS THE HEIGHT OF THE BUILDING OR OTHER INSTALLATION DOES NOT PERMIT SERVICE DROPS TO MEET THIS VALUE. THE CLEARANCE OVER RESIDENTIAL DRIVEWAYS ONLY MAY BE REDUCED TO 12'-0" (NEC TABLE 232-1 EXCEPTION 7 (c)).
2. THE SERVICE POLE MUST BE A MINIMUM OF 15'-0" FROM PRIMARY POLE UNLESS OTHERWISE APPROVED BY CO-OP.
3. ANTIOXIDANT COMPOUND IS REQUIRED ON ALL CONNECTORS TO ALUMINUM CONDUCTORS.

			DATE: 2-11-05	CATV SERVICE POLE WITH POWER SUPPLY POLE MOUNTED STANDARD ELECTRIC SERVICE REQUIREMENTS CULLMAN ELECTRIC COOPERATIVE CULLMAN, ALABAMA	SPEC. NO. OH-4
			DRAWN BY: S.T.W		
			APP'D BY: _____		
NO.	REVISION	DATE			